



15th ICC 2012
MUNICH · JULY 1 - 6

15th ICC 2012
MUNICH · JULY 1 - 6

15th
International
Congress
on Catalysis

in Munich, Germany

July 1 - 6, 2012

EXHIBITION &
SPONSORING

CONTENT	PAGE
ACCESS TO ICM	6
ACCOMMODATION	3
APPLICATION FORM EXHIBITION	9
APPLICATION FORM SPONSORING	11
ASSEMBLY / DISMANTLING PERIOD	3
CONTACT PERSON	2
DELIVERY / DELIVERY ADDRESS	3
ELECTRICAL INSTALLATION	3
EXHIBITOR PASS / PASS FOR ASSEMBLY AND DISMANTLING	3
FLOOR PLAN	7
GENERAL CONDITIONS OF PARTICIPATION	12
INSURANCE	4
OPENING HOURS OF THE EXHIBITION	4
PARKING SPACE	4
PERSON TO CONTACT	2
SECURITY	4
STAND CLEANING	4
STAND CONSTRUCTION	4
STAND PACKAGES	5
STORAGE OF EMPTIES	5
TRANSPORTATION OF GOODS	5
VISA FORMALITIES	5

PERSON TO CONTACT

Mr. Jürgen Stein
DECHEMA e.V., Exhibition - Congresses
Theodor-Heuss-Allee 25, 60486 Frankfurt/Main
GERMANY
☎ +49 69-7564-241
Fax +49 69-7564-273
E-Mail: stein@dechema.de

ACCOMMODATION

Reservation of accommodation for participants to ICC 2012 will be made by Hotel Service München. Reservations will be effective from January 2012. Please visit the congress website at www.icc2012.org.

Due to the fact that Munich attracts many visitors we highly recommend you to book your accommodation at your earliest convenience.

ASSEMBLY / DISMANTLING PERIOD

Assembly

Sunday, 1 July 2012 03.00 p.m. - 07.00 p.m.

Dismantling

Friday, 6 July 2012 05.30 p.m. - 09.00 p.m.

The exhibition ends on July 6, 2012 at 05:30 p.m.

Exhibitors may begin to dismantle stand construction directly after the end of the exhibition but not earlier.

DELIVERY / DELIVERY ADDRESS

All vehicles may only park within the loading area Hall B0 or Foyer Nord (see area map on page 6) during assembly and dismantling and loading and unloading.

Please label deliveries for your stand, sent by post or forwarding agent with the following address

ICM - International Congress Centre München
Messegelände
ICC Congress 2012 - booth no.
81823 München

Due to lack of space, deliveries can only be accepted from Friday, June 29, 2012.

ELECTRICAL INSTALLATION

The mains voltage on the exhibition ground is 220 V, AC, 50 Hz and threephase 380 V.

The basic stand equipment includes an electric main connection up to 2.0 kW, 1 socket and 2 spotlights for a stand with 6 m², 1 additional spotlight for each further 3 m².

The installations may be carried out solely by the authorized contractor.

The prices include electrical consumption.

For further electrical installations, please request a quotation: stein@dechema.de

EXHIBITOR PASS / PASS FOR ASSEMBLY AND DISMANTLING

The congress ticket (exhibitor pass) entitle the holder to enter the International Congress Centre München (ICM) during the event and during the assembly and dismantling periods. Assembly and dismantling passes only entitle the holder to enter the ICM during the assembly and dismantling period. Each exhibitor will receive one congress ticket which also admits the holder to the lectures and one pass for assembly and dismantling free of charge.

Additional passes for assembly and dismantling can be ordered, please contact stein@dechema.de.

Additional congress tickets can be ordered by using the regular online congress registration.

INSURANCE

The organizers cannot accept responsibility for loss or damage to the private property of participants and accompanying persons which may occur either during or arising from the congress. Participants should therefore take whatever steps they consider necessary regarding insurance.

OPENING HOURS OF THE EXHIBITION (all times subject to change)

Sunday, July 1, 2012 approx. 06.00 p.m. - 09.00 p.m.

Monday, July 2, 2012 approx. 08.30 a.m. - 09.00 p.m.

Tuesday, July 3, 2012 approx. 09.00 a.m. - 06.00 p.m.

Wednesday, July 4, 2012 approx. 09.00 a.m. - 12.00 a.m.

Thursday, July 5, 2012 approx. 09.00 a.m. - 05.30 p.m.

Friday, July 6, 2012 approx. 09.00 a.m. - 05.30 p.m.

PARKING SPACE

A multi-storey car park west is integrated into the Congress Centre. Parking space is available at a charge of € 10.00 per day for passenger cars only.

SECURITY

DECHEMA is in charge of general security. The exhibitor is liable for all exhibition goods on his stand. The halls are closed during the night. If required a quotation of stand surveillance can be solicited by DECHEMA. DECHEMA does not accept any liability for damage or loss to any items.

STAND CLEANING

The daily stand cleaning service is included. For additional services please contact: stein@dechema.de.

STAND CONSTRUCTION

Example:

9 m² (3m x 3m) stand
with two open sides

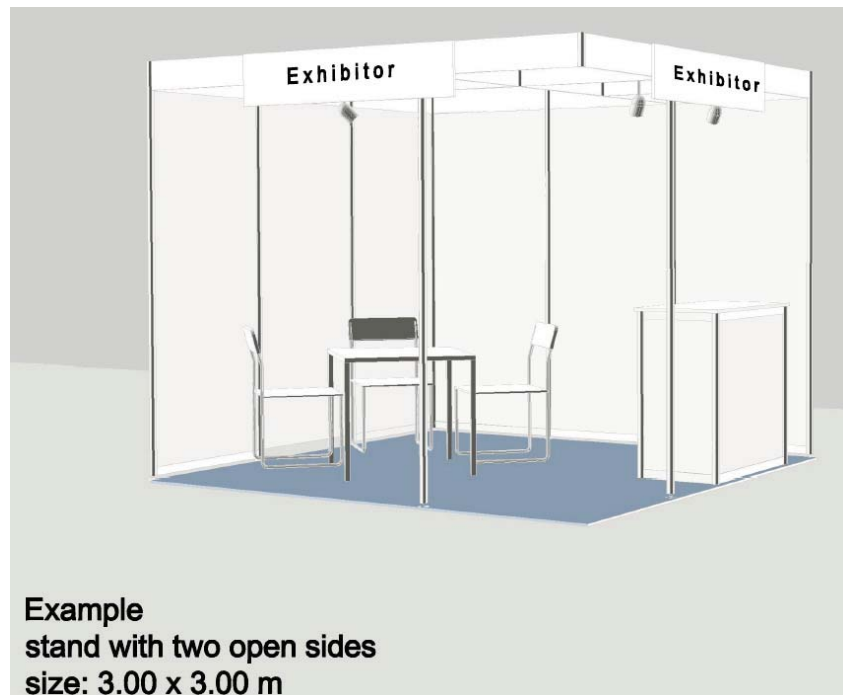

Should you wish to position elements differently a stand plan is required. Please return the stand in good condition. Adhesive labels or strips must be removed from the wall elements and stand construction materials, otherwise you will be billed for the cost of replacing them.

If you need more stand partitions we will be pleased to submit you an individual offer.

STAND PACKAGES

We offer the following stand packages (all prices are subjected to statutory VAT):

The general stand package includes

- External walls, 2,50 m high, white (modular stand system)
- 1 sideboard with lockable door
- Fascia, white, with company name lettering
- Spotlights
- Floor covering, grey
- 1 table and 3 chairs
- Main electricity connection up to 2.0 kW incl. 1 socket, 230 V
- Daily cleaning & 1 waste paper basket
- 1 free registration for the scientific programme (congress ticket)

The stand package 1 for EUR 3.000 includes in addition

- 6 m² booth (3m x 2m)
- 1 staff members free

The stand package 2 for EUR 4.000 includes in addition

- 9 m² booth (3m x 3m)
- 2 staff members free

The stand package 3 for EUR 5.000 includes in addition

- 12 m² booth (4m x 3m)
- 1 lockable cabin
- 3 staff members free

The stand package 4 for EUR 6.000 includes in addition

- 15 m² booth (5m x 3m)
- 1 lockable cabin
- 3 staff members free

STORAGE OF EMPTIES

The storage of stand materials or empties during the exhibition is not possible in the ICM. Extra service has to be booked, please contact stein@dechema.de.

TRANSPORTATION OF GOODS

The floor conditions (stone floor) only allow the use of hand lift trucks and trolleys with rubber tyres. Due to the size of the exhibition, please bring your own hand lift trucks or trolleys. Depending on availability these can be rented in the ICM for a deposit during assembly and dismantling.

VISA FORMALITIES

Participants from a number of countries may need an entry visa for Germany.

It is recommended to apply for a visa well in advance of the symposium. If a formal invitation letter is needed please fill out the form available on the website www.icc2012.org.

Access to ICM

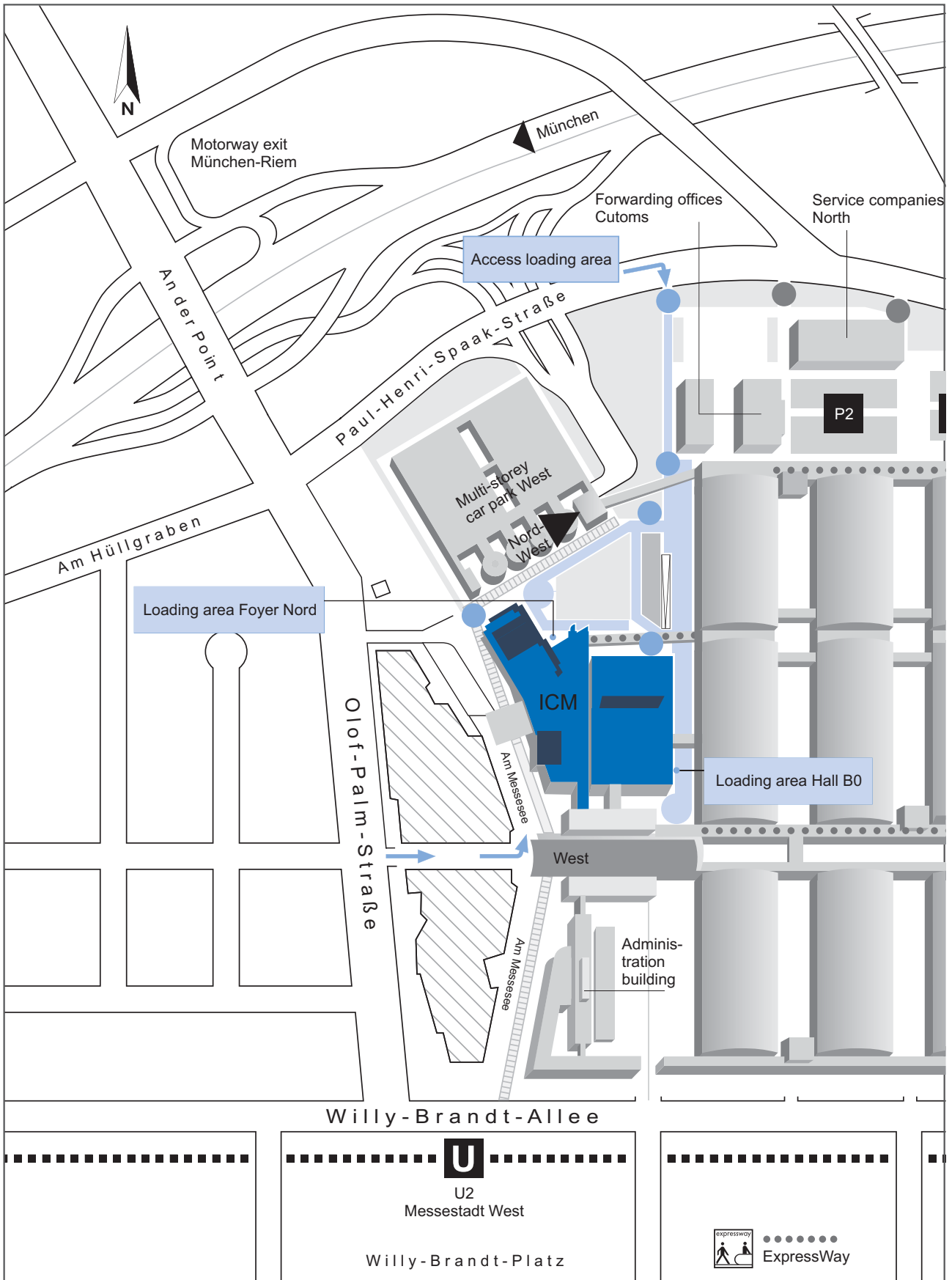

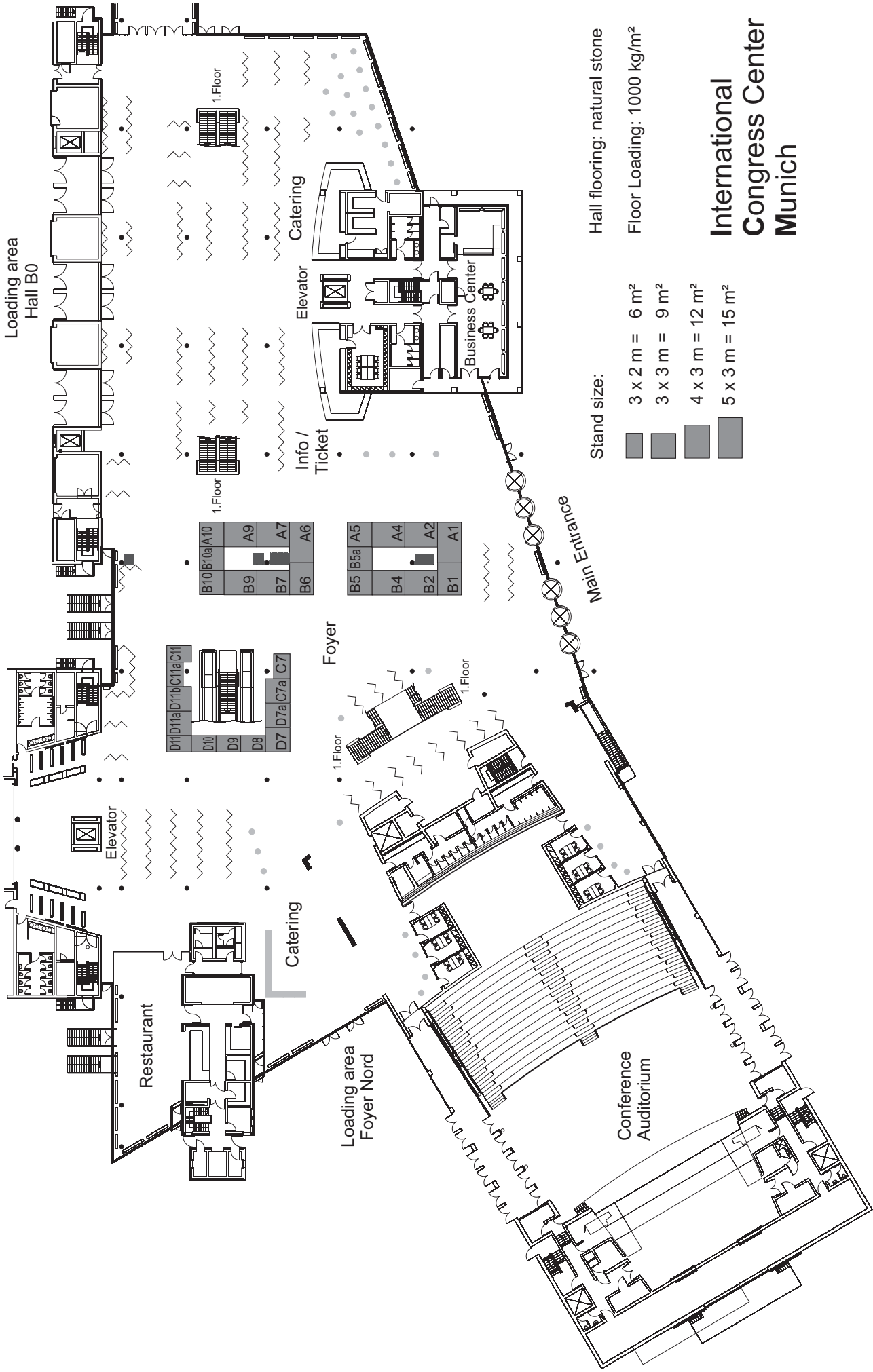

Loading area
Hall B0

Restaurant

Catering

Foyer

Loading area
Foyer Nord

Conference
Auditorium

Main Entrance

B10 B10a A10
B9 A9
B7 A7
B6 A6

B5 B5a A5
B4 A4
B2 A2
B1 A1

D11 D11a D11b C11a C11
D10
D9
D8
D7 D7a C7a C7

1. Floor

1. Floor

Catering

Elevator

Info /
Ticket

Business Center

Hall flooring: natural stone

Floor Loading: 1000 kg/m²

Stand size:

- 3 x 2 m = 6 m²
- 3 x 3 m = 9 m²
- 4 x 3 m = 12 m²
- 5 x 3 m = 15 m²

International Congress Center Munich

Application Form / Exhibition



15th International Congress on Catalysis, 1 - 6 July 2012, Munich, Germany

Correspondence address

Company _____

Street _____ P.O.B. _____

Postal code / Place / Country _____

Commercial register no. _____ Manager _____

Person to contact / Department _____

Phone _____ Telefax _____

E-mail _____ Internet _____

We order the following stand package:

Package 1 6 m² EUR 3.000 **Package 2** 9 m² EUR 4.000

Package 3 12 m² EUR 5.000 **Package 4** 15 m² EUR 6.000

more than 18 m² _____ m²

We present exhibits

no yes height _____ m weight _____ kg/m²

Invoice address if different to address above

Company _____

Street _____ P.O.B. _____

Postal code / Place / Country _____

Person to contact / Department _____

E-mail _____

The undersigned undertakes to accept the conditions of participation of the exhibition as legally binding.
All prices are subject to statutory VAT.

Place / Date

Company stamp / Signature

Telefax
+49 (0)69 75 64-273

E-Mail
stein@dechema.de
GERMANY

DECHEMA e.V.
Exhibition

P.O. Box 15 01 04
D-60061 Frankfurt am Main

Please keep one copy for your files and return to 

Application Form / Sponsoring

The 15th International Congress on Catalysis cordially welcomes your sponsoring activities. Please find a detailed description of our standard sponsoring packages below. If you require additional information or you are considering different ways of supporting the congress, please contact the congress office directly to discuss additional opportunities for your involvement.

Correspondence address / Person to contact:

Company _____

Person to contact _____

Phone _____

E-Mail _____

SPONSORING PACKAGES AND OPPORTUNITIES FOR PARTICIPATION^{*)}

All sponsors will have their company logo placed on the website.

Rhodium Level - Grand Patrons € 50,000

- Logo placed on congress banner
- Logo placed on delegate bags
- Logo placed on Munich City Guide - distributed to all participants
- Advertisement page on Munich City Guide, format 15 x 7,8 cm - distributed to all participants (one sponsor for backside page, two more sponsors for page U2 or U3)
- Logo placed inside final programme
- Full page advertisement inside final programme (one sponsor for backside page, two more sponsors for page U2 or U3)

Platinum Level - Patrons € 25,000

- Logo placed on congress banner
- Logo placed on delegate bags
- Logo placed inside final programme
- Full page advertisement inside final programme

Gold Level - Sponsors € 10,000

- Logo placed inside final programme
- Half page advertisement inside final programme

Silver Level - Benefactors € 5,000

- Logo placed inside final programme
- Quarter page advertisement inside final programme

Bronze Level - Supporters € 2,500

- Logo placed inside final programme

^{*)} All prices are subject to statutory VAT. We shall pay the total amount on receipt of the invoice:

Place / Date

Company stamp / Signature

Please keep one copy for your files and return to 

Telefax
+49 (0)69 75 64-176
E-Mail
martz@dechema.de

DECHEMA e.V.
Congress Office
Postfach 15 01 04
D-60061 Frankfurt am Main

GENERAL CONDITIONS OF PARTICIPATION

1. **Event**
15th International Conference on Catalysis
2. **Organiser**
DECHEMA Gesellschaft für Chemische Technik und Biotechnologie e.V.
Executive Director: Kurt Wagemann, Prof. Dr.
Exhibition Management: Andreas Förster, Dr. rer.nat
Technical Management: Jürgen Stein

Postal address: DECHEMA e.V.
Postfach 150104
60061 Frankfurt am Main
GERMANY

Tel.: +49 69 7564-241, Fax: +49 69 7564-273
email: stein@dechema.de
3. **Venue**
ICM - Internationales Congress Center München
Messe München GmbH
Messegelände
81823 München
4. **Exhibition Dates**
Sunday, July 1 - Friday, July 6, 2012
5. **Participants**
All companies and institutions offering services or products in the field of catalysis.
6. **Application, Approval, Allocation**
On returning the completed and signed, Application-Form Exhibitor the exhibitor is legally committed to participate in the present events. Any and all reservations and conditions contained in this application shall not be legally binding. The rental contract becomes legally binding when the stand rent is invoiced. When allocating the stands DECHEMA will endeavour to take account of any wishes expressed by the exhibitor. Stands will be allocated on the basis of the technical requirements of the exhibitor. The exhibitor has no right to a certain location or size of the stand. DECHEMA is entitled to allocate a different stand to the exhibitor even after a stand has been allocated. If the stand is fundamentally different to the wishes expressed by the exhibitor, the stand allocation will be binding if DECHEMA receives no written objection from the exhibitor within two weeks after the date of allocation. Changes of allocated stands or changes to the stands themselves do not represent a basis for the right of cancellation or claims for compensation against DECHEMA.
7. **Rental Charges, Conditions of Payment**
We offer stand packages of 6 m² for € 3.000, 9 m² for € 4.000, 12 m² for € 5.000 and 15 m² € 6.000 plus statutory VAT; the minimum stand size is 6 m². The rental payment shall be due on month April, 2012.
All amounts are to be paid into one of the accounts listed on the invoice. In case of foreign currency payments, any exchange rate differences or costs which arise shall be borne by the exhibitor. If the exhibitor defaults payment, DECHEMA is entitled, as lump sum compensation for delayed payment, to invoice the arrears to the level of % above the respective reference rate of the European Central Bank. If the exhibitor is more than 30 days in arrears, DECHEMA is entitled to dispose of the stand without need of further notice. In this case claims for compensation on the part of the exhibitor are ruled out. DECHEMA reserves the right to assert its own claims for compensation. Exhibits and other items on the stand shall serve as security for all claims arising from the rental agreement that DECHEMA asserts against the exhibitor.
DECHEMA shall be liable only for gross negligence and intent for any damage to such items.
8. **Refund of VAT to enterprises in non-EU countries**
Enterprises not established in the EU, who receive goods or services for their businesses in Germany, can under certain conditions receive a refund of the invoiced VAT through the recovery of input tax procedure. Further information in English can be found at http://www.steuerliches-info-center.de/en/003_menu_links/001_CC/004b_Umsatzsteuer/024_Unternehmer_Drittstaaten/068_Aenderungen/index.php. Please direct any inquiries concerning refund of VAT by e-mail to vat@germantaxes.info
9. **Services rendered by DECHEMA**
The general stand package includes:

External walls, 2,50 m high, white (modular stand system),
1 sideboard with lockable door,
Fascia, white, with company name lettering,
Spotlights,
Floor covering, grey,
1 table and 3 chairs,
Main electricity connection up to 2.0 kW incl. 1 socket, 230 V,
Daily cleaning & 1 waste paper basket,
1 congress ticket for the scientific programme.

Media package:
Recognition of your company in alphabetical order in the final programme and on the ICC 2012 website.
Non-use of the services covered by the rent does not entitle the exhibitor to a reduction of the rent.
10. **Cancellation of Contract**
If an exhibitor withdraws from the contract, DECHEMA is entitled to claim lump-sum compensation from the exhibitor. The amount of compensation shall be determined by the time of cancellation and shall amount to:
(1) 50% of the stand rent after dispatch of the stand confirmation and before the outstanding rent is due 1, May 2012
(2) the total stand rent after the rent has become due 1, June 2012.
This also applies analogously to a reduction in stand area. The decisive criterion is the date of receipt of the withdrawal declaration at DECHEMA. If DECHEMA cancels the contract because of default in payment on the part of the exhibitor, the aforementioned values and times shall apply for the amount of lump-sum compensation. The decisive criterion is the date on which the exhibitor falls into arrears.
The exhibitor shall have the possibility to prove that DECHEMA either has no loss or a loss that is lower than the lump sums.
11. **Obligation of Acceptance**
For the duration of the contract, the exhibitor is obliged to use the stand in accordance with the Conditions of Participation and ensure that the stand remains sufficiently manned during the opening hours of the event.
12. **Stand Construction**
DECHEMA shall be responsible for the overall design of the exhibition grounds. Stand design and construction are subject to the Technical Guidelines of the ICM München (see www.icc2012.org), applicable laws, safety provisions and official regulations.
All stand structures, lighting and graphic displays exceeding the height of 2.50 m are subject to approval of DECHEMA and ICM München. Stand structures, lighting and graphic displays are permitted to a total height of 2.50 m. Above a height of 2.50 m the stand walls facing adjoining stands must be kept neutral, white and clean.
Decorations must be in line with the technical character of the event. The exhibitor is fully responsible and accountable for the safety of exhibits and structures.
The requirements and approval procedure are detailed in the Exhibitor Manual which will be provided to the exhibitor in the beginning of the year of 2012.

GENERAL CONDITIONS OF PARTICIPATION

The assembly will be on July 1, 2012. The dismantling shall begin directly after the end of the exhibition on July 6, 2012 and must be finished at 09:00 pm. Any exhibits which remain on the stands after the expiration of the dismantling deadline may be removed and stored at the exhibitor's expense. At the end of the exhibition the stand must be returned in the same condition in which it was taken over. The exhibitor shall be liable for damages caused by himself or his agents to the halls, stands and stand fittings he obtained on rental basis. The foyers are covered with natural stone. At the end of the exhibition, the stand area shall be returned in the same condition as it was taken over.

13. Load-bearing Capacity

At the ICM München the maximum permissible load-bearing capacity of the floor is 10 kN/m². It is not possible to drive forklift trucks through the foyers. The transportation of pallets and similar articles with a lifting truck is only possible with bright rubber tires.

14. Exhibits, Film and Video Equipment/Screens, Performances, Visitor Information

Particularly large (more than 2.50 m height) and heavy exhibits (max. load bearing capacity on ground floors 1000 kg /m²) as well as exhibits shown in operation, audio visual installations and performances are subject to the approval of DECHEMA. The noise level must not exceed 70 db (A), measured from the edge of the aisle. All exhibits shall comply with the usual international safety provisions. The handling of inflammable solvents and gases shall be prohibited. Live animals may not be exhibited.

Performances are only permitted to give information related to the characteristics and functions of exhibits. Visitor information and visitor surveys by the exhibitor shall only be provided inside the exhibition stand. Only factual visitor information, which explains the functioning of the exhibits and the related processes, is admitted. Retail sales on exhibition stands are prohibited.

If the above conditions are not met, DECHEMA has the right to ban the use of such equipment. The exhibitor has no right to claim for any compensation.

15. Liability and Insurance

The exhibitor is liable for all losses, including damage to buildings and exhibition installations, that the exhibitor, its employees, its agents or auxiliary staff inflict on others within the context of the exhibition. If a claim is made by a third party against DECHEMA as a result of damage caused by the exhibitor, the exhibitor shall indemnify DECHEMA from these claims. This especially applies in the case of a claimed violation of patents or commercial property rights.

16. It is the responsibility of the exhibitor to provide sufficient insurance protection for itself and its staff.

DECHEMA is liable to the exhibitor only for damages caused by gross negligence or intent on the part of its employees. One particular exclusion from liability is that of damage occurring by fire, water, explosion, storm or other acts of god, or by violent assault, theft, breaking and entry, failure of supply systems and similar causes, provided they are not attributable to gross negligence or intent of DECHEMA, its agencies or employees. This applies to damage caused by the public as well. When there is reason for liability on the part of DECHEMA, the level of liability to the exhibitors who are engaged in commerce is limited to types of damage ordinarily occurring in the course of exhibitions or congresses.

DECHEMA accepts no liability for damage that is either not typical of such contracts or cannot be foreseen. DECHEMA shall naturally not be liable for any losses incurred.

17. Enforcement of Claims

All claims of the exhibitor shall be made to the DECHEMA in writing no later than by the last day of the exhibition. Claims made at a later date cannot be considered.

18. Patents, Copyrights and other Property Rights

DECHEMA is not liable to exhibitors for third party violation of patents, copyrights and other commercial property rights in connection with the exhibition. The exhibitor shall indemnify DECHEMA against all claims asserted by third parties against DECHEMA as a result of alleged violation of patent rights, copyrights or other rights. The exhibitor accepts that DECHEMA has the right to take photographs, make film or video recordings during the event, and that DECHEMA may use these for its own information purposes.

19. Reservations

Statutory rules or provisions of the local exhibition corporation shall prevail over these Conditions of Participation. To the extent that the Conditions of Participation deviate from the statutory rules and provisions, the exhibitors shall have no right of recourse to DECHEMA. Should DECHEMA not be able to hold the event as a result of unforeseen circumstances or an insufficient number of participants, the exhibitors will be informed immediately. DECHEMA will then charge for services provided up to this time as well as for special services that have already been ordered, in the amount of the costs incurred. DECHEMA's claim to the agreed stand rent shall no longer apply. Should DECHEMA be forced to cancel or curtail the commenced event for reasons of force majeure, the exhibitor shall have no claim to a refund or waiving of the stand rent.

20. Data Protection

The exhibitor expressly declares his agreement that, in order to fulfil this contract, DECHEMA is authorized to store and pass on the necessary personal data of the exhibitor for automatic data processing purposes. The exhibitor therefore waives his right to further notification in accordance with the „Federal Data Protection Act“ (Bundesdatenschutzgesetz).

Other Legal Matters and Concluding Provisions

DECHEMA is entitled to give immediate notice of termination of the contract, if presentation of a judicial decision proves that the exhibitor violates the provisions of patent, free trade or other laws as a result of the nature of his display or exhibits; if, despite DECHEMA's demand, the exhibitor fails to redress violations of the Conditions of Participation immediately; or if the exhibitor persistently disrupts the procedure of the exhibition or the keeping of the peace. After giving notice of termination, DECHEMA may close the exhibitor's stand and have it dismantled at the exhibitor's cost. The exhibitor has no entitlement to a refund of any payments he has made.

The House Rules of the Messe München GmbH, the Technical Guidelines and other provisions that the exhibitor receives before the event start are an integral part of the contract.

21. Place of Jurisdiction

The parties to the present contract are in agreement that Frankfurt am Main shall be the legal place of jurisdiction for all claims asserted by either of them under the present Agreement.

The present Agreement shall be governed by German law.

Frankfurt am Main, 2011

DECHEMA

Gesellschaft für Chemische Technik
und Biotechnologie e.V.